

Dump truck

Assembly Instructions

CREATIVE PARK

<http://www.canon.com/c-park/en/>



View of completed model

* This model was designed for Papercraft and may differ from the original in some respects.

Tools

- Scissors
- Ruler, set square
- Glue (Wood glue or craft glue recommend)
- Exhausted ballpoint pen (out of ink)
- Toothpicks (for use in applying glue)
- Tweezers (useful for handling small parts)
- Pencil

Assembly tip

- Write the number of each part on the reverse side of the part in pencil upon cutting it out, to be sure you can tell which part is which later.
- Before gluing, crease the paper along mountain and valley fold lines. Trace along the folds with a ruler and an exhausted ballpoint pen (out of ink) to get a sharper fold.
- Make sure rounded sections are nice and stiff.

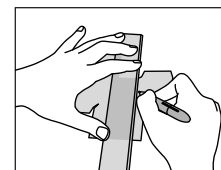

Key to symbols

Pattern

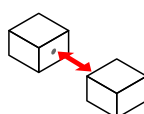
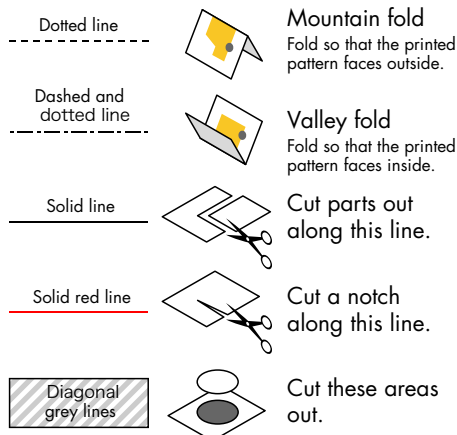

The dots show where to glue the pieces together. Glue the pieces together as shown in the following examples. Some parts must be glued together along the cut surfaces.



Red dot

Glue parts with the same number together. (Numbers are not printed on very small parts.)



Green dot

Glue areas within the same part together.



Blue dot

Glue to the reverse side of the specified part.

Assembly instructions

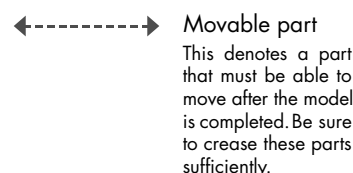
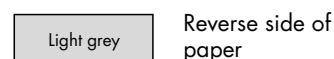
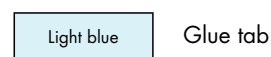
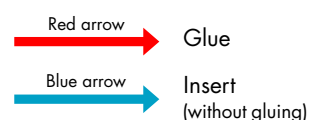

Glue, scissors and other tools may be dangerous to young children so be sure to keep them out of the reach of young children.

- Assembly Instructions: Ten A4 sheets (No. 1 to No. 10)
- Build this model with careful reference to the Assembly Instructions.

A

Assemble the cab.
Glue flaps a, b, c, d and e in order.

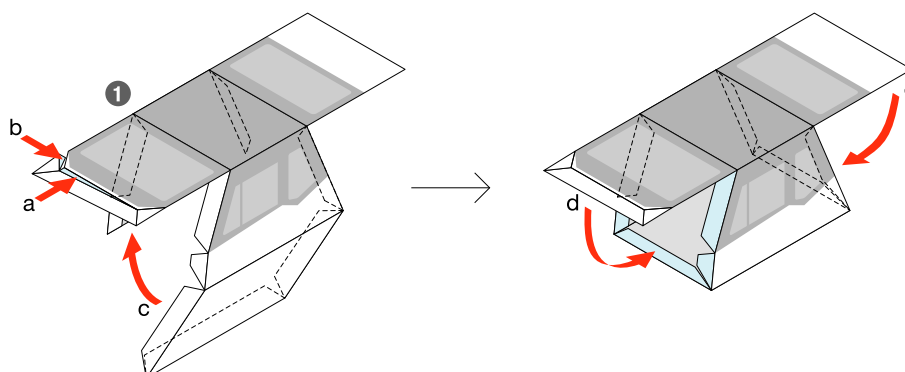

B

Glue flaps a, b, c, and d in order.

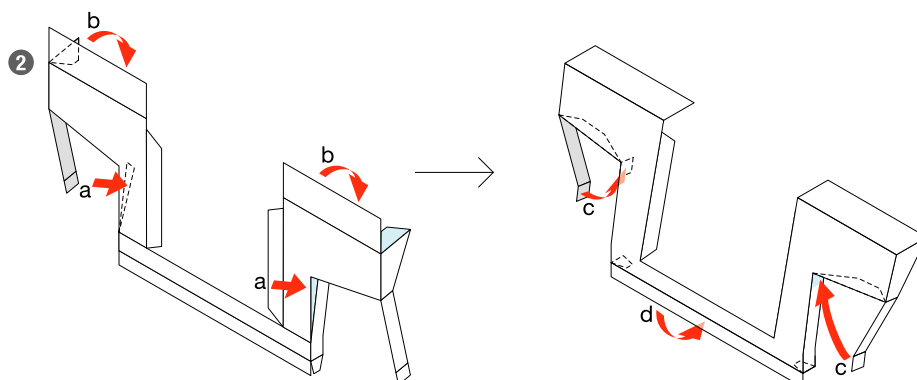

C

After first assembling the front section,
assemble the rear section following steps a and b, in that order.

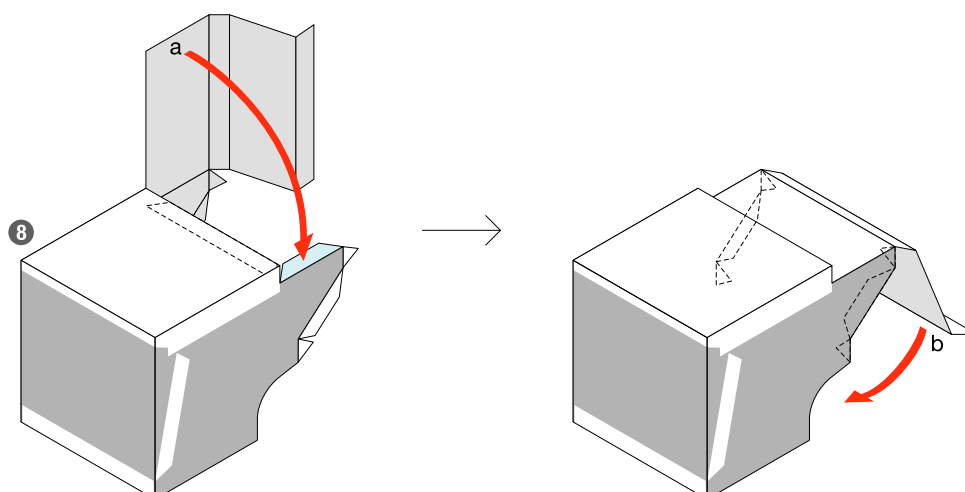

D

Turn part 3 over and glue the mud flaps (parts 4 and 5) in place before assembly.

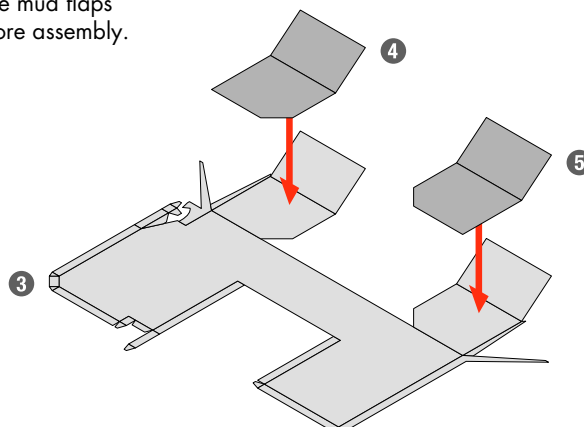

E

Glue flaps a, b, c, d, e and f in order.

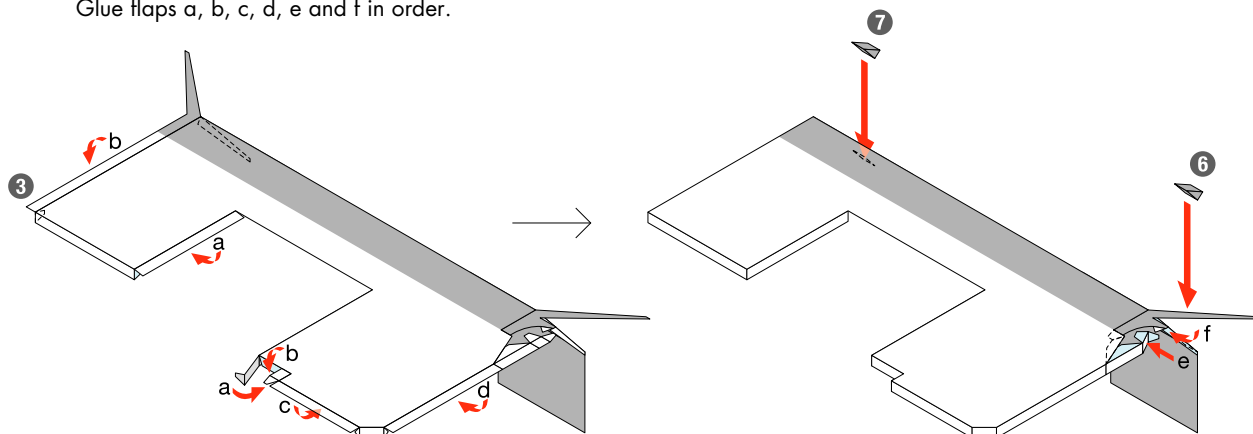

F

Check the glue positions on the side while attaching this part.

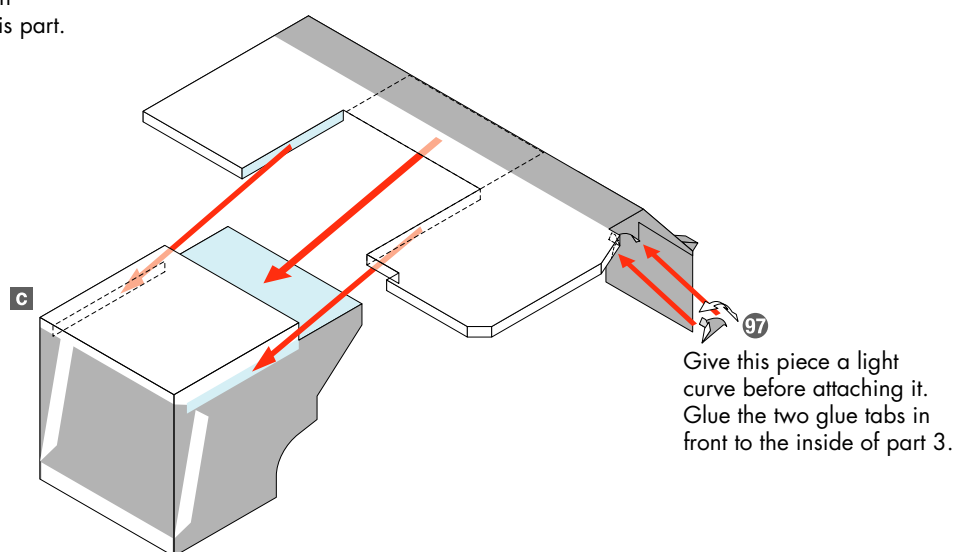

G

Check the glue positions on the side while attaching part **B**.
Apply glue to the rear side of part 3 as well.

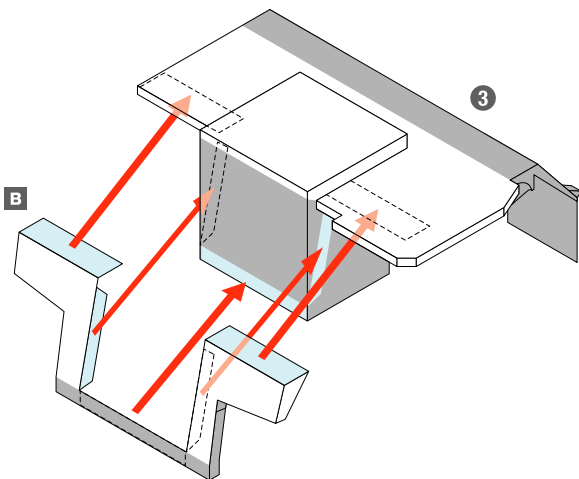

H

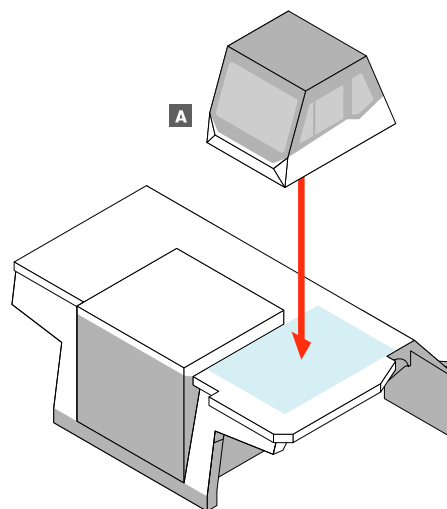

I

Assemble the base of the body.

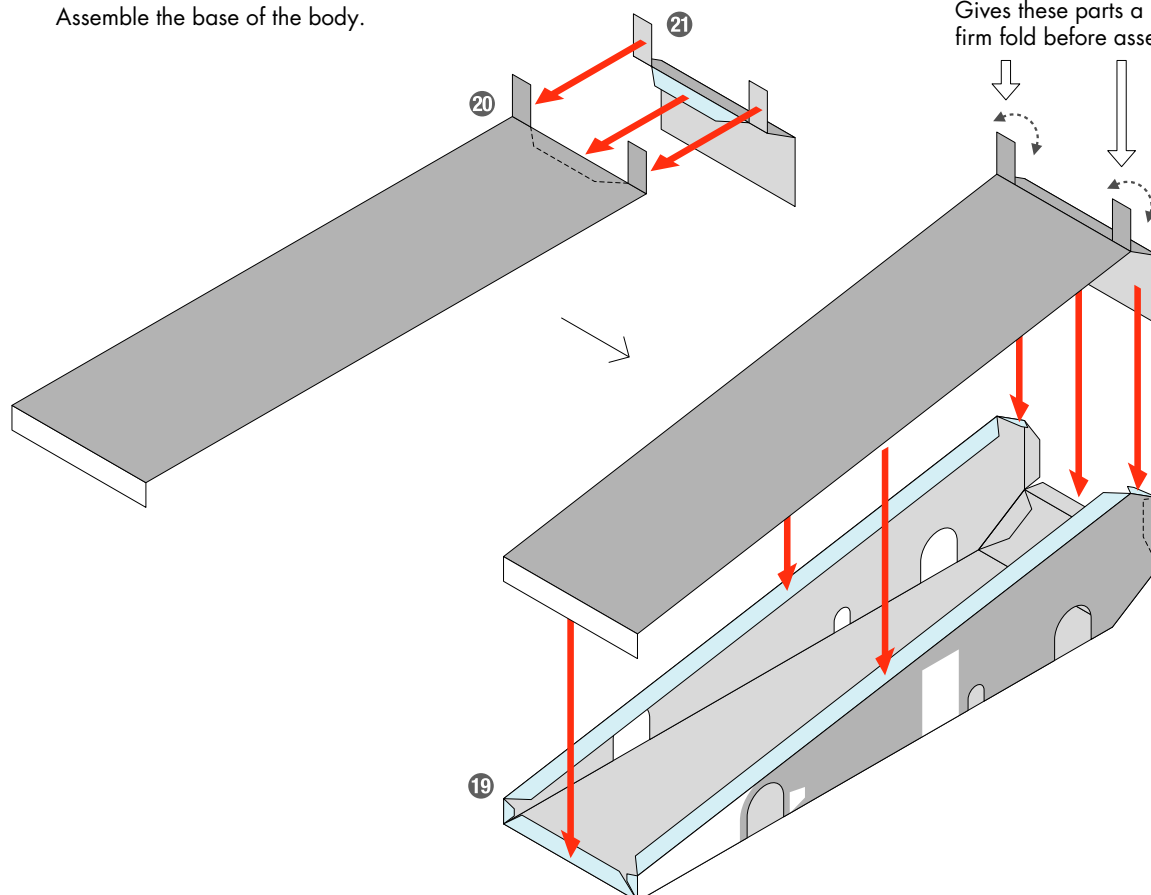

J

Assemble and attach the front axle housing.

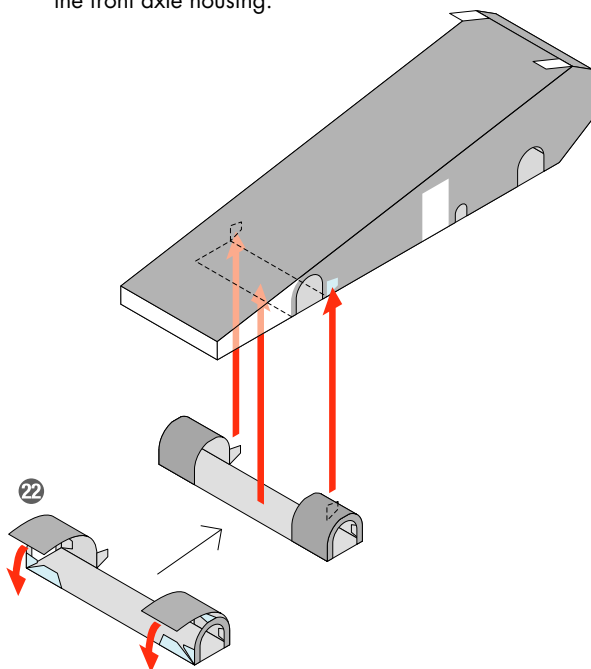

K

Attach the cab to the base.

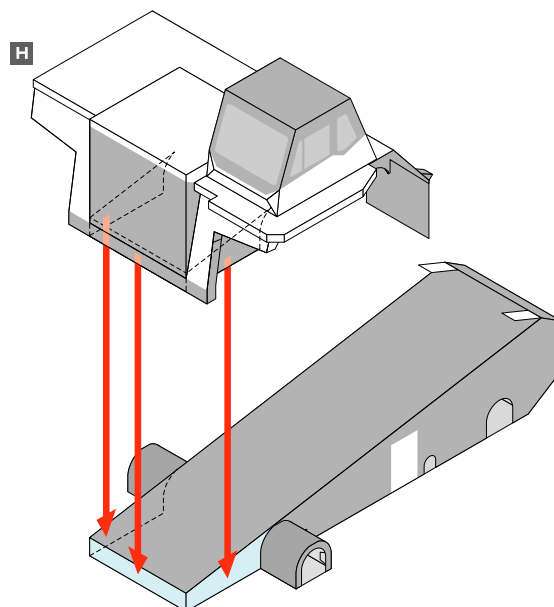

L

Assemble the outside of the carrier.
Take care not to apply glue to the printed surface.

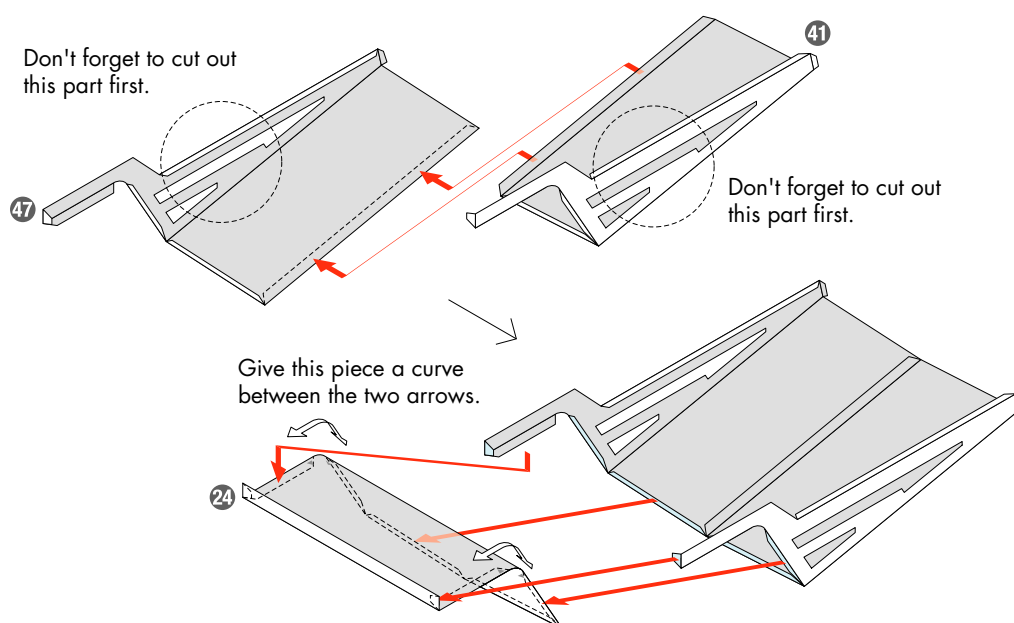

M

Assemble the inside of the carrier.
Take care not to apply glue to the printed surface.

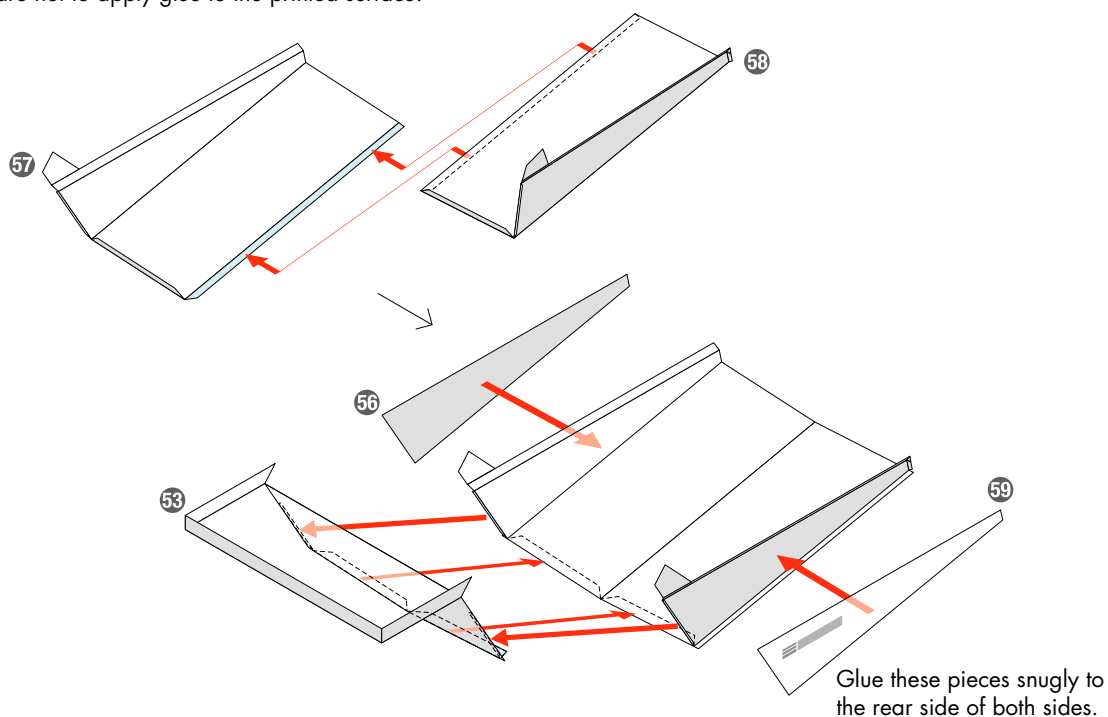

N

Assemble the outside and inside of the carrier.
After applying glue to the glue tabs on the left and right ends, glue the rear sides of the other paper surfaces to each other snugly.

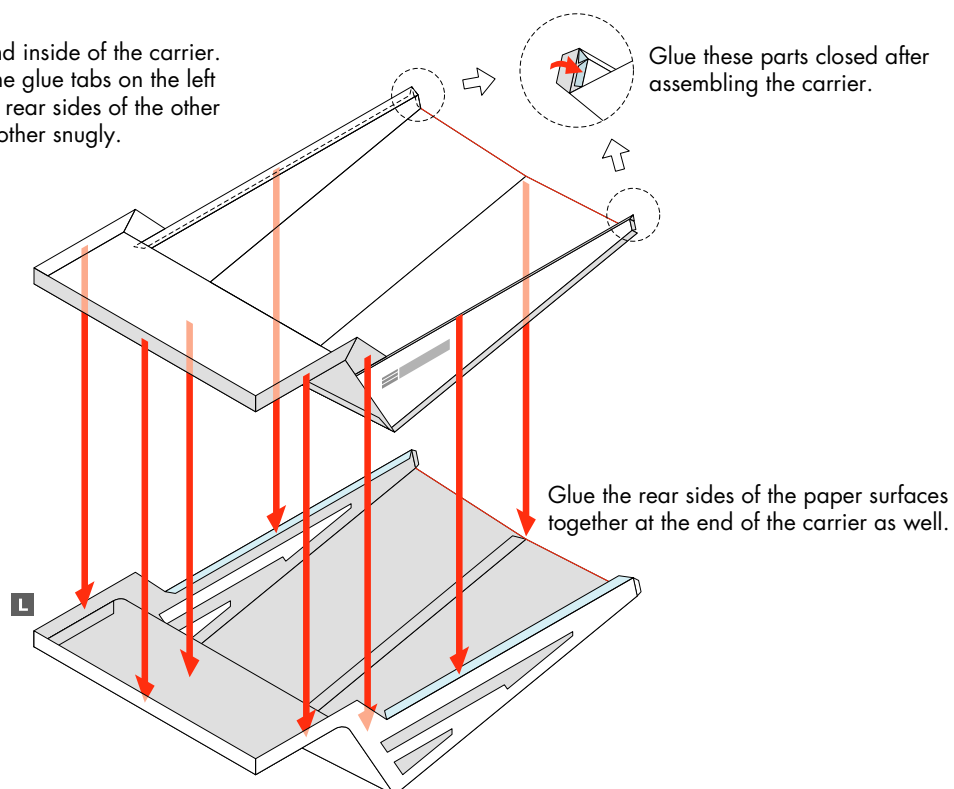

O

Assemble the bottom of the carrier.
Glue these parts in place in numerical order,
taking care to ensure the carrier does
not become warped.

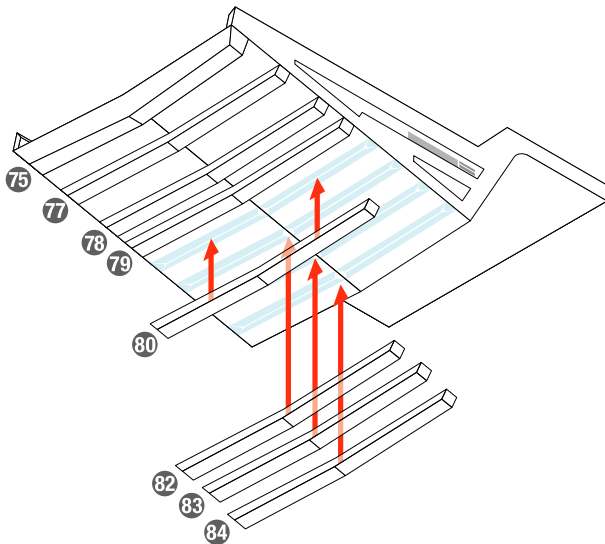

P

Glue parts 27 and 28
to the cuts in the paper,
matching their seams
to each other.
Attach these to part 29
so that the seams are
aligned with the arrow.

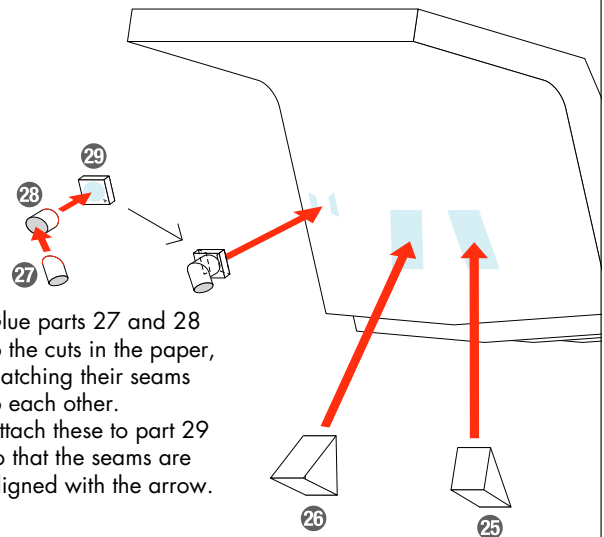

Q

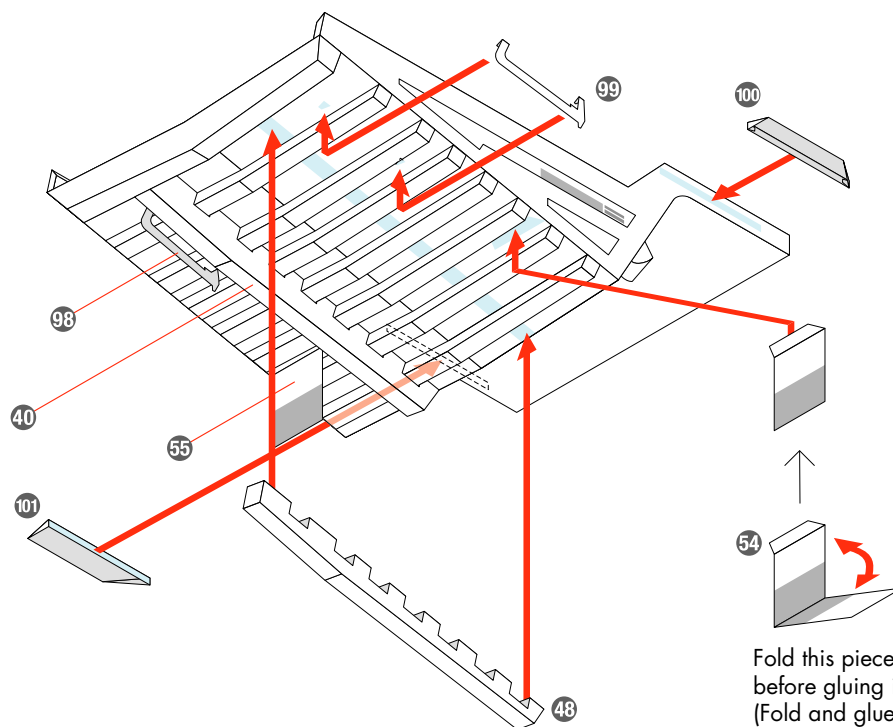

Fold this piece twice
before gluing it in place.
(Fold and glue part 55
in the same way.)

R

Assemble the axle used to move the carrier, and attach it to the body.

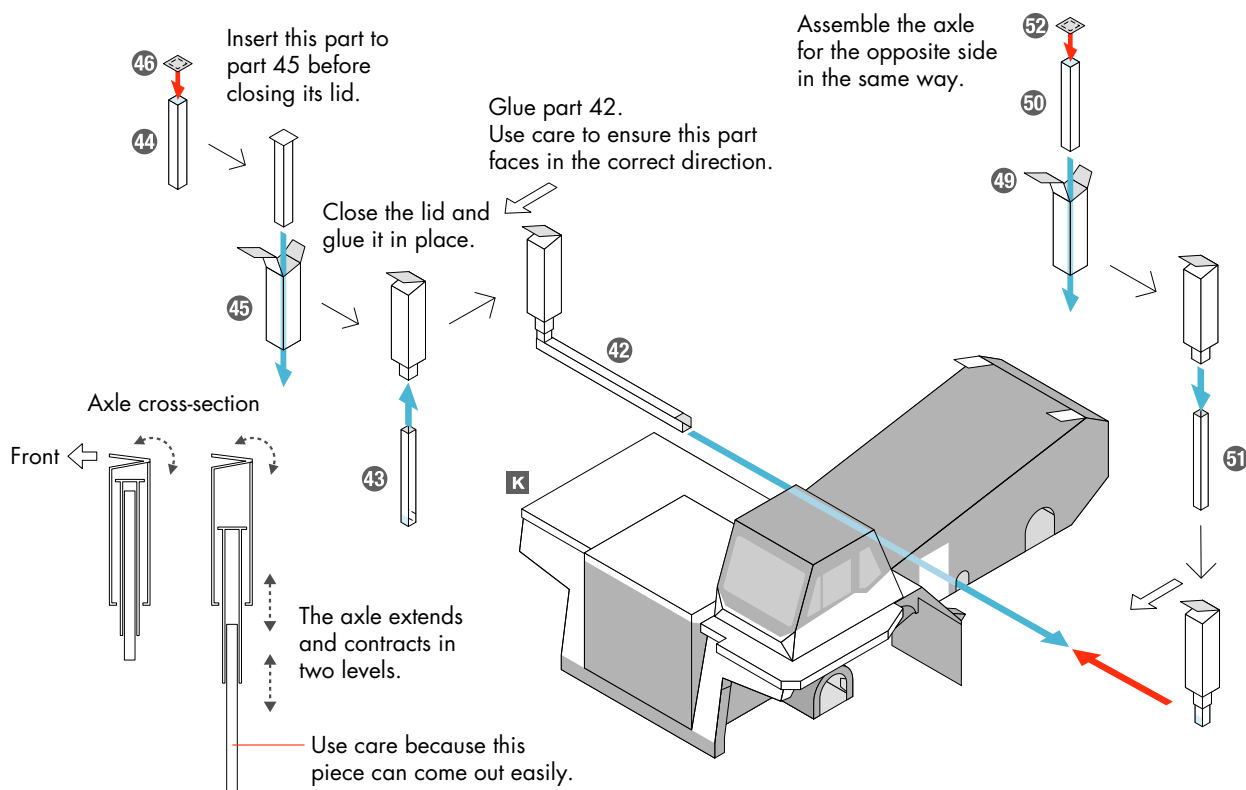

S

Assemble the left front and rear wheels.

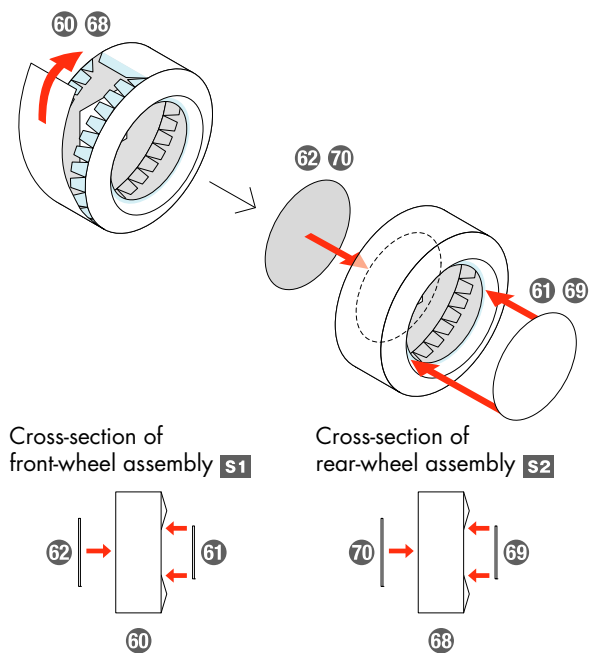

T

Assemble the right front and rear wheels.

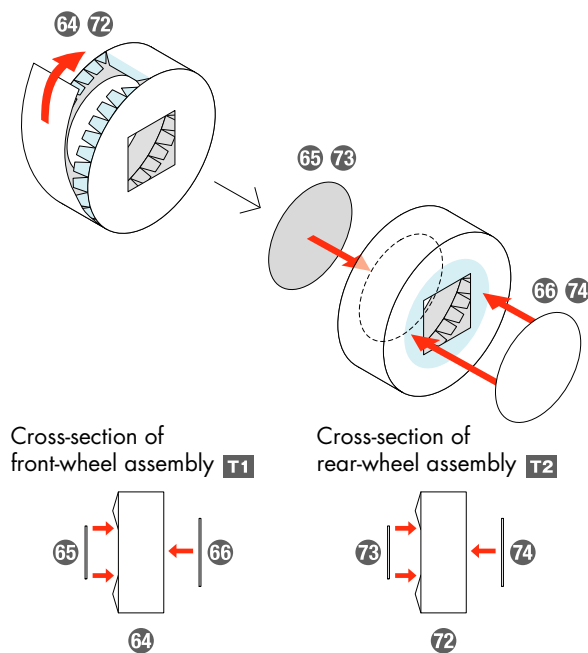

U

Assemble the left and right inner rear wheels.

Inside of right rear wheel **U1**

76

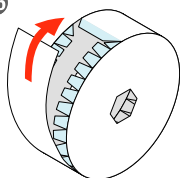

Inside of left rear wheel **U2**

81

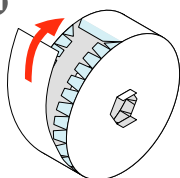

V

After attaching wheels to one side of each axle, insert the axles through the body and attach the other wheels. Take care to assemble these parts in the correct order, referring to the illustration below.

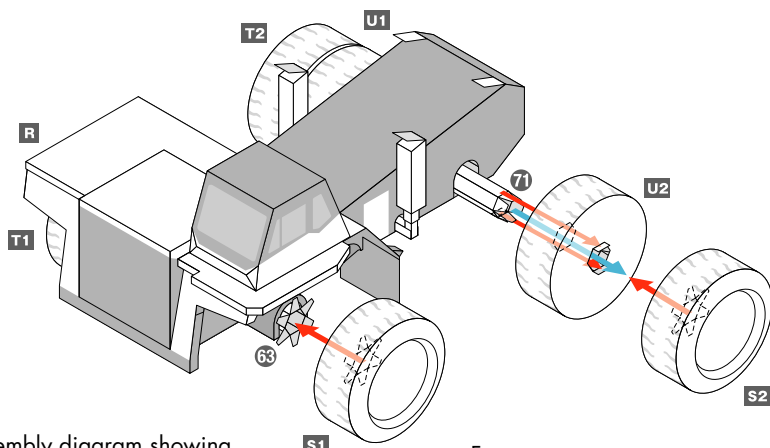

Assembly diagram showing view from underside

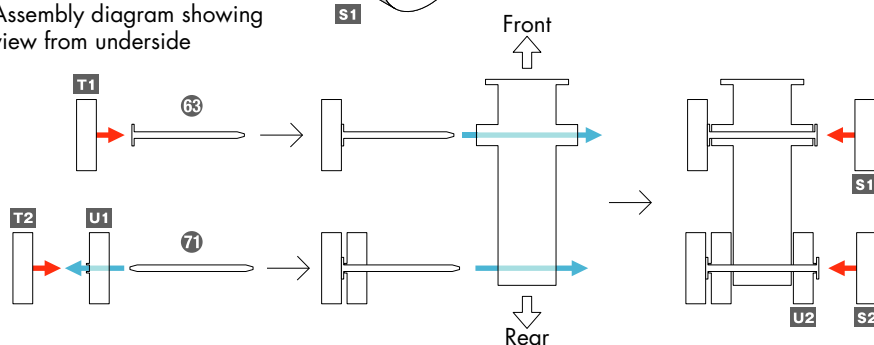

W

Glue parts with no glue tabs to the areas cut out of the paper parts. Attach these parts to the body so that the arrows align.

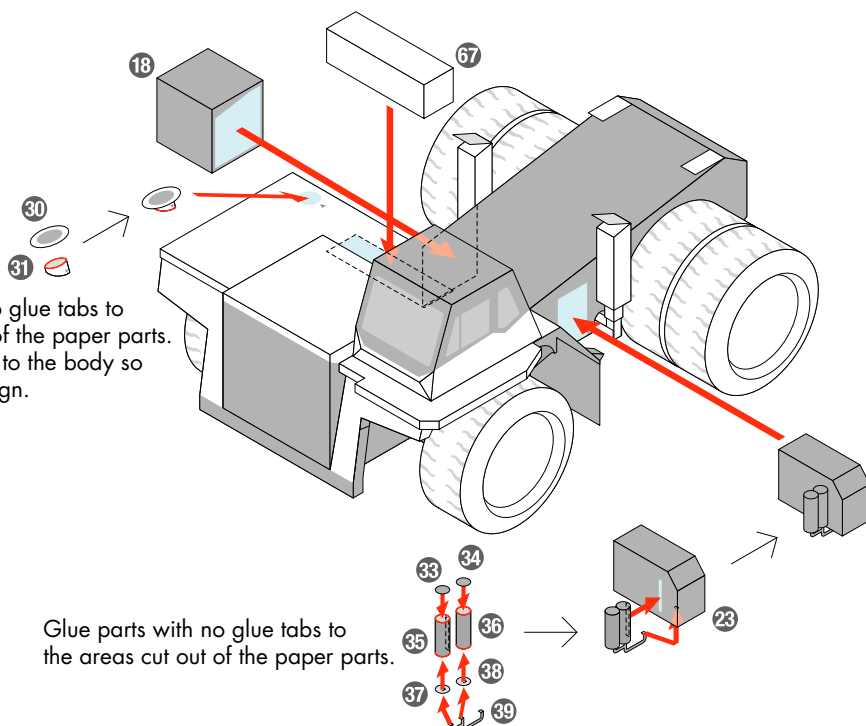

Glue parts with no glue tabs to the areas cut out of the paper parts.

X

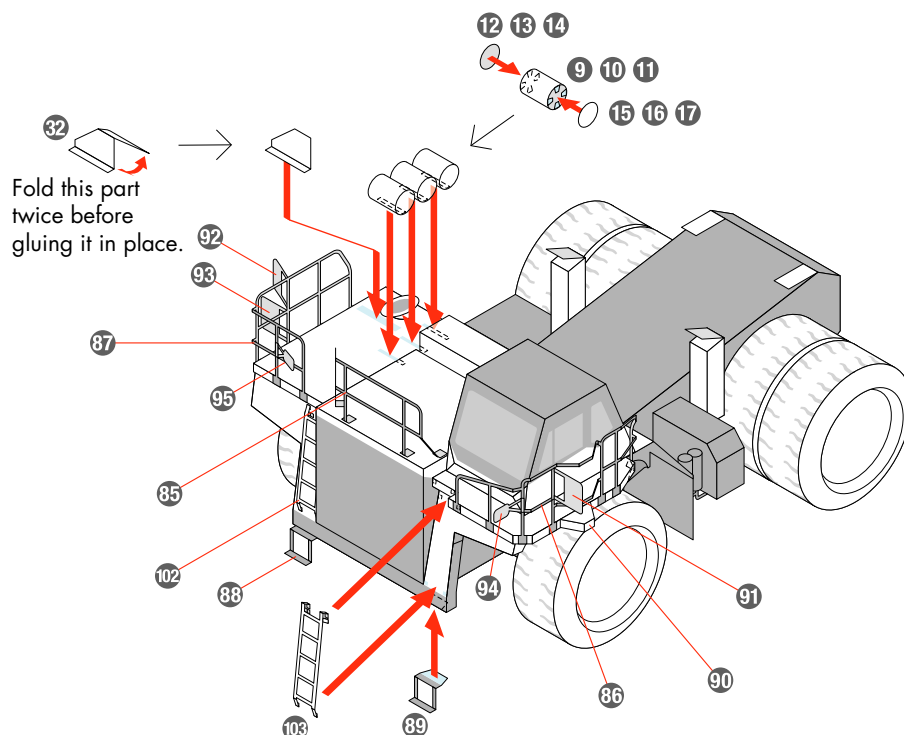

Y

Glue the carrier to the body.

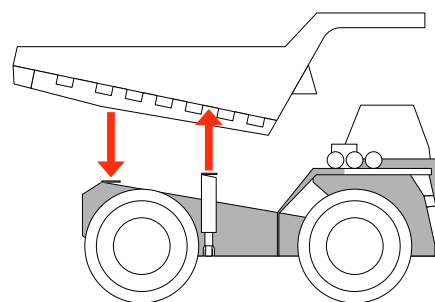
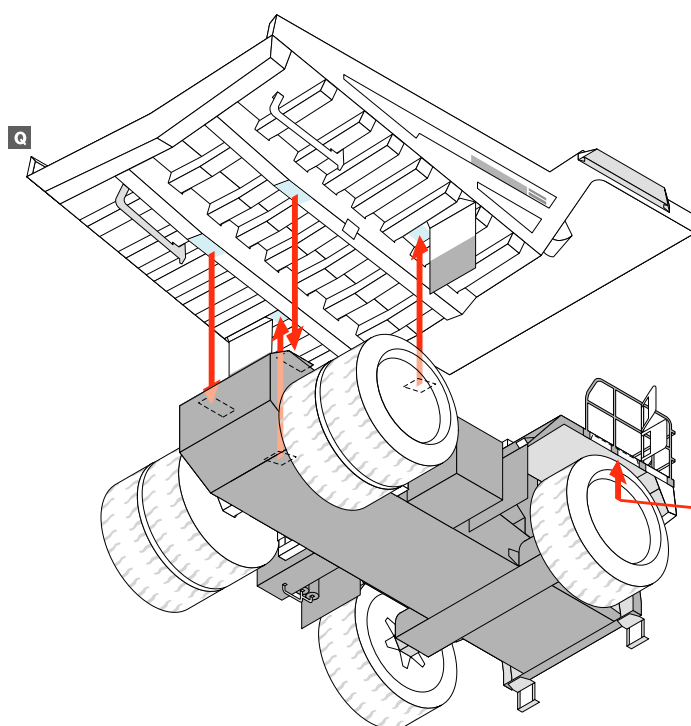

Side view

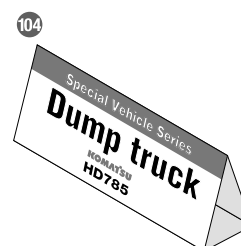

Finished!

Last, assemble the nameplate and display it together with your model.